

KINTEK



SONDER-WERKZEUGHALTER



SPECIAL TOOLHOLDERS



СПЕЦИАЛЬНЫЕ РЕЗЦЕДЕРЖАТЕЛИ



PORTEOUTILS SPECIAUX



PORTAUTENSILI SPECIALI



专用刀柄

YOU JI



KINTEK

VIA GORETTA 88/G - 10072 MAPPANO
FRAZIONE DI CASELLE (TO) - ITALIA
tel. +39.011.9968065 fax +39.011.9965662
<http://www.kintek.it> e-mail: Info@kintek.it

YOU JI

VTL1000,1200,1600,2000,2500
YV1000,1200,1600

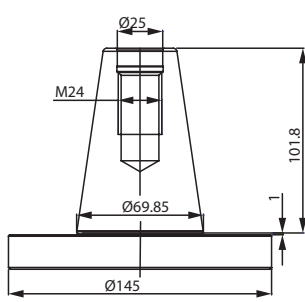

ATC series

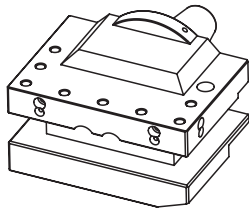

Face and O.D. cutting holder

153-11501 32x32 L160

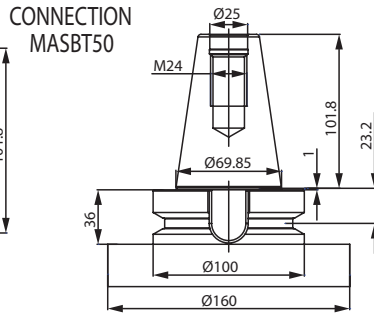

ATC+C series
(Turning tool)

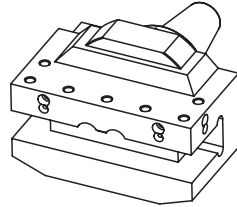

153-11504 32x32 L160

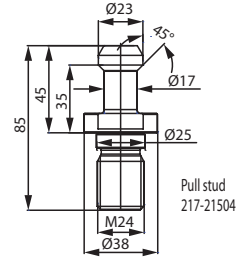

ATC+C series
(Driven tool)

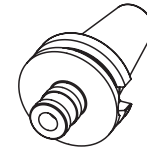

Tension and compression tapping head

M3320 BT50H81GR1.DC
M3430 BT50H102GR2.DC
M3530 BT50H135GR3.DC

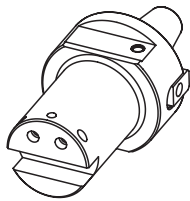

Face and O.D. cutting holder

151-11505 25x25 L200

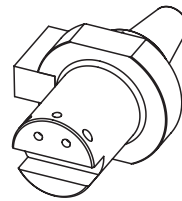

151-11504 25x25 L200

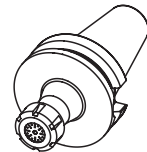

ER collet chuck

214-31438 BT50H100ER25 AD+B
214-31434 BT50H100ER32 AD+B
214-31436 BT50H100ER40 AD+B

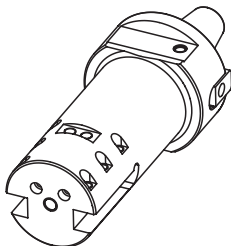

Face and I.D. cutting holder

152-11507 25x25 L300

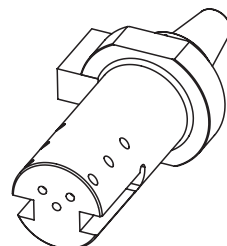

152-11508 25x25 L300

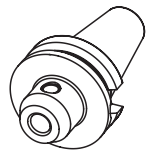

End mill holder

213-11430 BT50H80WE20 AD+B
213-11431 BT50H100WE25 AD+B
213-11432 BT50H105WE32 AD+B
213-11433 BT50H120WE40 AD+B

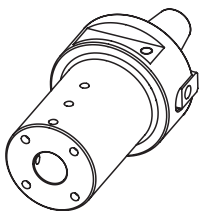

Toolholder for boring bar

155-21503 D40 L215
155-21506 D60 L215
155-21505 D60 L315

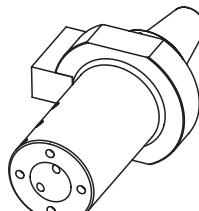

155-21510 D40 L250
155-21508 D50 L250
155-21509 D60 L250

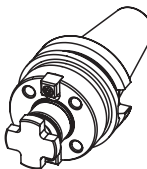

Facemill holder

216-71520 BT50H60D32F
216-21502 BT50H70D40
216-21503 BT50H80D60