

KINTEK



SONDER-WERKZEUGHALTER



SPECIAL TOOLHOLDERS



СПЕЦИАЛЬНЫЕ РЕЗЦЕДЕРЖАТЕЛИ



PORTEOUTILS SPECIAUX



PORTAUTENSILI SPECIALI



专用刀柄

NAKAMURA TOOLING





NAKAMURA TOME

TW10

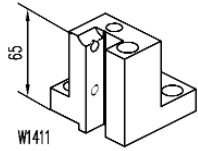

W1411

Face and O.D. cutting holder

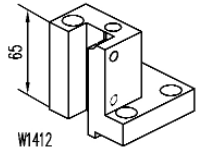

W1412

Face and O.D. cutting holder

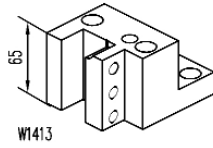

W1413

Face and O.D. cutting holder

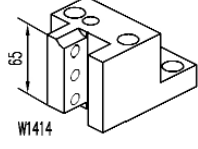

W1414

Face and O.D. cutting holder

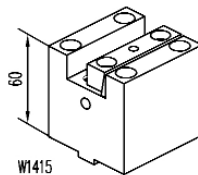

W1415

Face and I.D. cutting holder

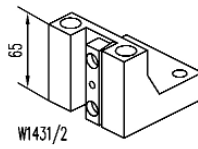

W1431/2

Face and O.D. cutting holder

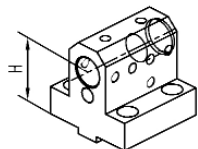

W1417 D25 (H=55 mm)
W4437 D25 (H=75 mm)

Combi toolholder for boring bar and insertdrill

ø25 mm

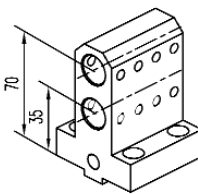

W1418 D25

Double toolholder for boring bar

ø25 mm

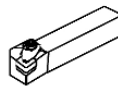

Qualified tool
20x20 mm

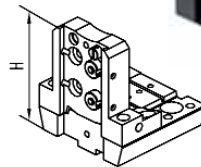

121-22075 (h=26 mm H=95 mm)
121-22076 (h=32 mm H=100 mm)



Cut-off holder



Cut-off tool

CONNECTION

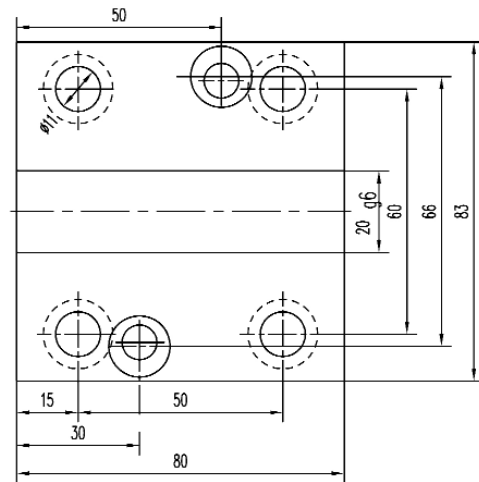

ACCESSORIES

Boring bar sleeve and throw-away drill socket

- 739.0125.020 TW10 (ø20 mm)
- 739.0125.016 TW10 (ø16 mm)
- 739.0125.012 TW10 (ø12 mm)
- 739.0125.010 TW10 (ø10 mm)
- 739.0125.008 TW10 (ø8 mm)
- 739.0125.006 TW10 (ø6 mm)

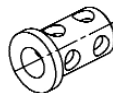

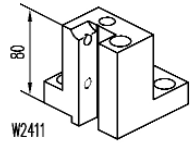

W2411

Face and O.D. cutting holder
25x25 mm

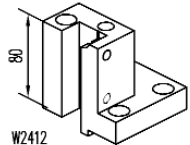

W2412



Face and O.D. cutting holder
25x25 mm

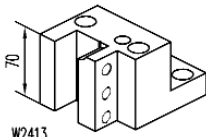

W2413



Face and O.D. cutting holder
25x25 mm

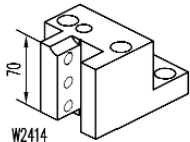

W2414



Face and O.D. cutting holder
25x25 mm

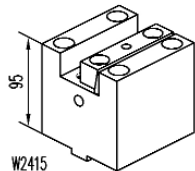

W2415



Face and I.D. cutting holder
25x25 mm

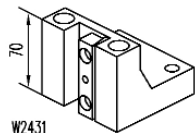

W2431



Face and O.D. cutting holder
20x20 mm

ACCESSORIES

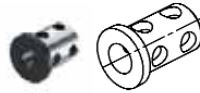

Boring bar sleeve and throw-away drill socket

- 739.0132.020 TW20 (ø20 mm)
- 739.0132.016 TW20 (ø16 mm)
- 739.0132.012 TW20 (ø12 mm)
- 739.0132.010 TW20 (ø10 mm)
- 739.0132.008 TW20 (ø8 mm)

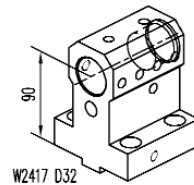

W2417 D32

Combi toolholder for boring bar and insertdrill

ø32 mm

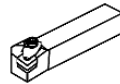

Qualified tool

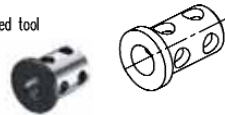

Boring bar sleeve

- 739.0125.020 TW20 (ø20 mm)
- 739.0125.016 TW20 (ø16 mm)
- 739.0125.012 TW20 (ø12 mm)
- 739.0125.010 TW20 (ø10 mm)
- 739.0125.008 TW20 (ø8 mm)

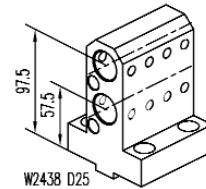

W2438 D25

Double toolholder for boring bar

ø25 mm

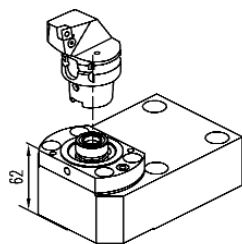

121-22083

Face and O.D. cutting holder
HSK 50 A+C

CONNECTION

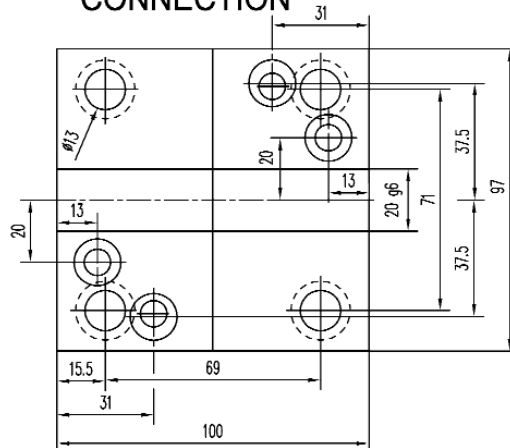

NAKAMURA TOME

WT100

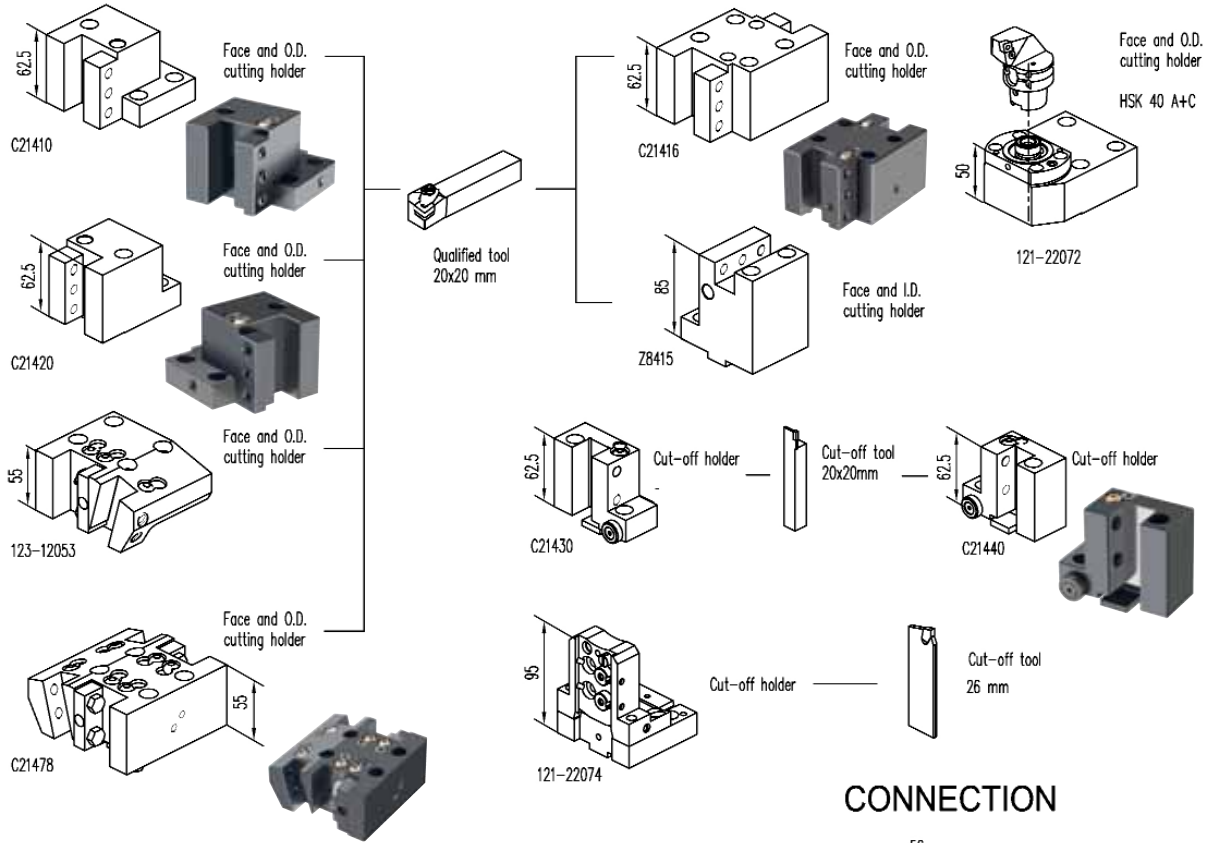

CONNECTION

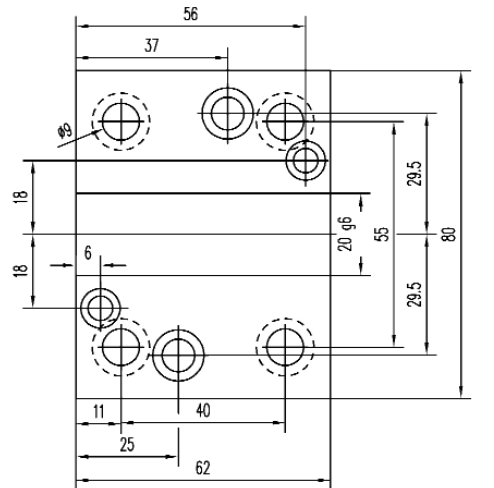

ACCESSORIES

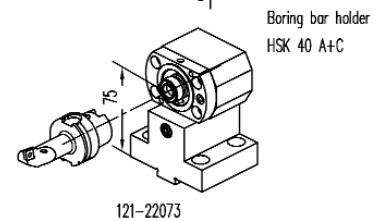
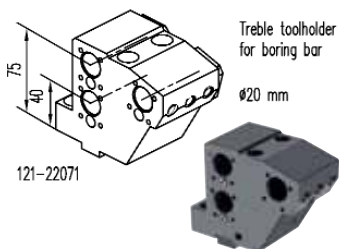
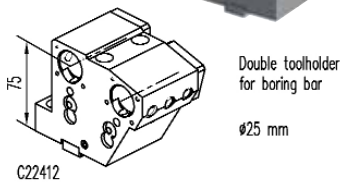
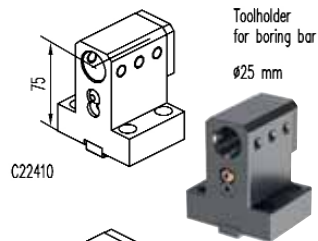

NAKAMURA TOME

WT150 - WTW150 - WTS150
WT250 - SC150 - SC250

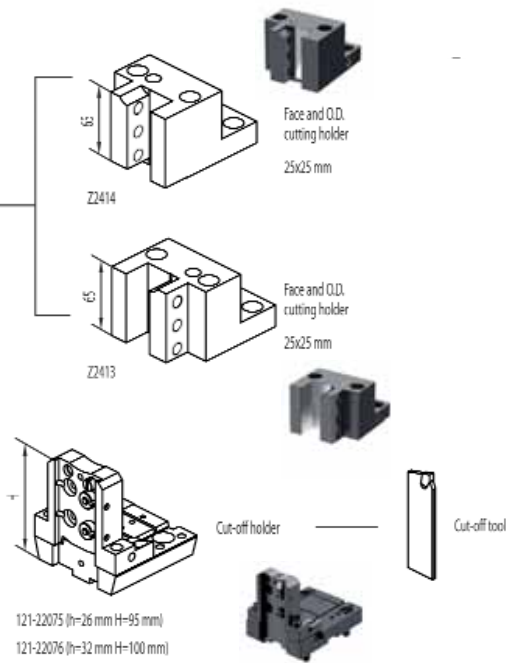
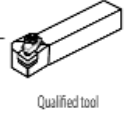
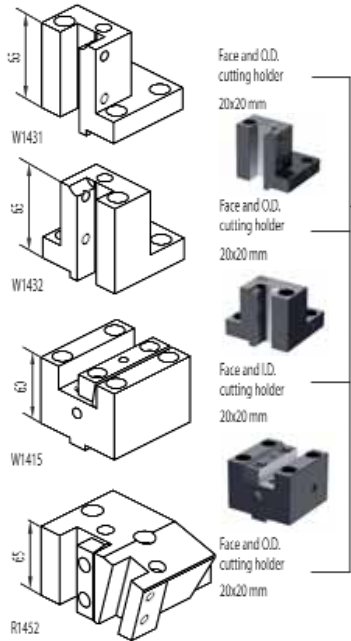

CONNECTION

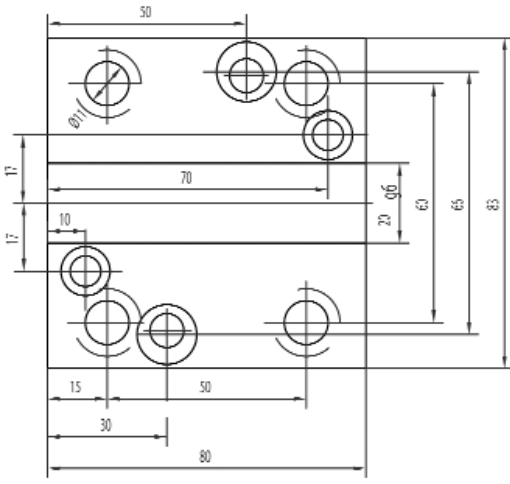

ACCESSORIES

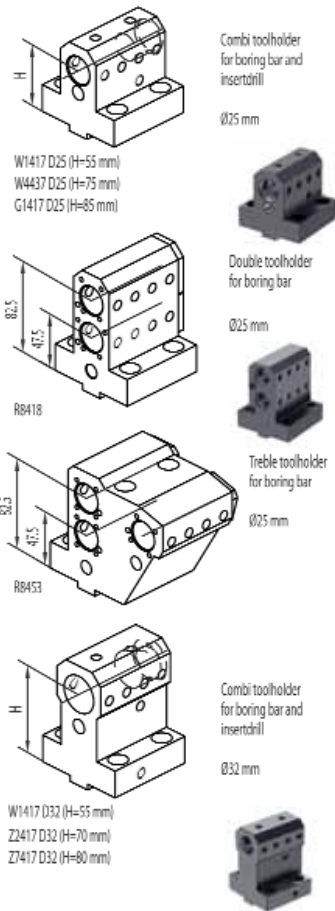

KINTEK

VIA GORETTA 88/G - 10072 MAPPANO
FRAZIONE DI CASELLE (TO) - ITALIA
tel. +39.011.9968065 fax +39.011.9965662
<http://www.kIntek.it> e-mail: Info@kIntek.it